

#15457 Filed This 5 day of Jan. 1971

And Recorded in Vol. 4H Page 171 of 3:44 P.

Ollie Farnsworth
Register Mesne Conveyance Greenville County, S. C.

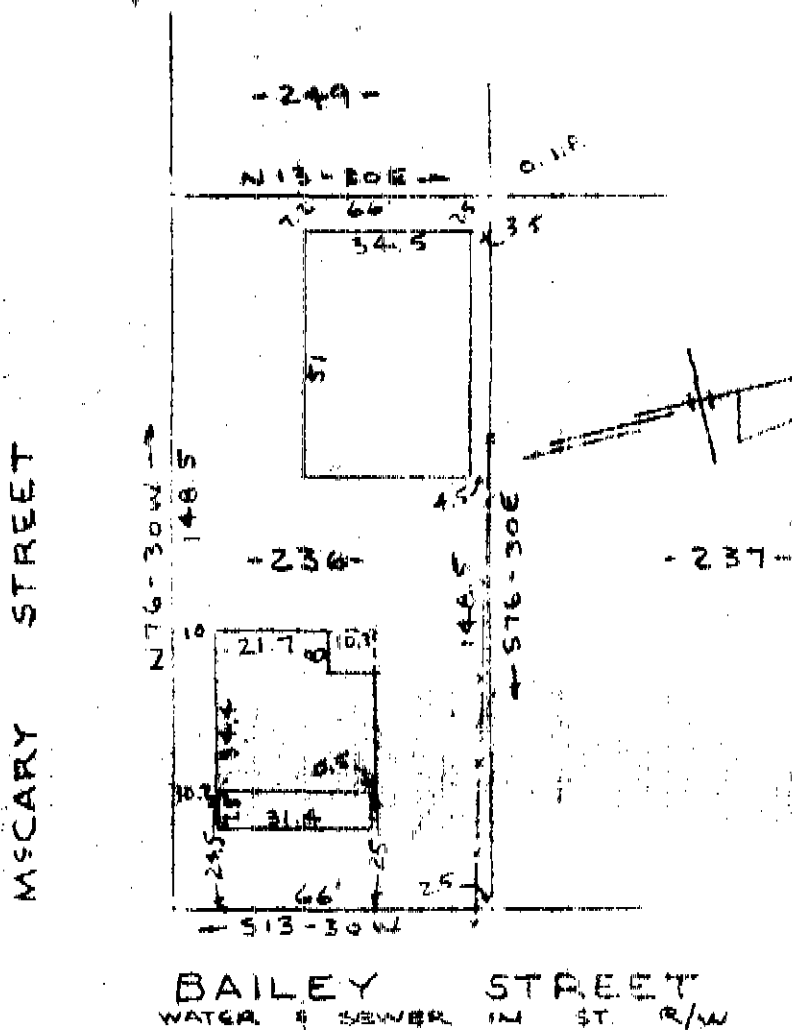

GREENVILLE
JAN 5 3 04 PM '71
OLLIE FARNSWORTH
R.H.C.

PROPERTY OF
JOHN SIDNEY BARTON & CARLENE BISHOP BARTON
NEAR GREENVILLE, S. C.
SCALE: 1"=40' 31 DEC 1970

This is to certify that on the 31st day of December 1970, I surveyed the property shown on this plat, being known as lot 236 on plat of THE McCARY TRACT and recorded in the RMC Office Greenville County, S.C., in Plat Book "A" at Pages 278 & 279 and also being known as PROPERTY OF JOHN SIDNEY BARTON & CARLENE BISHOP BARTON and recorded in the RMC Office Greenville County, S.C., in Plat Book 4-H at Page 171; and that the property lines, walls and buildings are as shown hereon, and that the walls and buildings located on said lot do not encroach or project on adjacent street or property, and that no adjacent walls or buildings encroach or project on said premises, and no power lines cross this property except as shown hereon.

✓ R. B. Bruce
R. B. Bruce, ALS #1952

JAN 5 1971
15457

RECORDING FEE
PAID \$ 504

CAROLINA SURVEYING COMPANY
Greenville, S. C.

86/43

171